

Quick Installation Guide

Applicable Model:

TL-WA854RE

Method ONE: Quick Setup using the WPS Button

Method TWO: Setup using your Web Browser

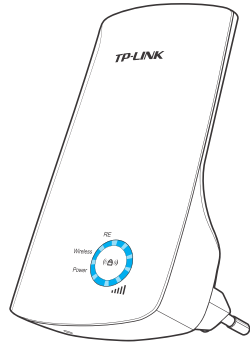

7106504592 REV1.0.0

LED Explanation

RE

On: A secure connection has been established.

Flashing: TL-WA854RE is establishing a secure connection.

Off: No connection is active.

Wireless

Off: The wireless function of TL-WA854RE is disabled.

Flashing: The wireless function of TL-WA854RE is enabled.

Power

On: TL-WA854RE is on.

Off: TL-WA854RE is off.

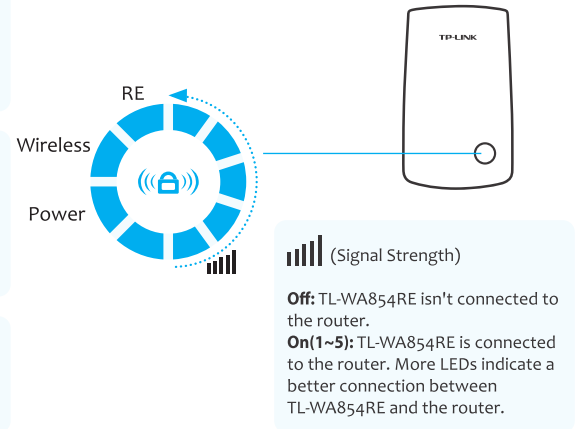

Method ONE

Quick Setup using the WPS Button

Use this if your router or AP supports WPS

1 Power on

Plug your TL-WA854RE in **near** your router or AP.

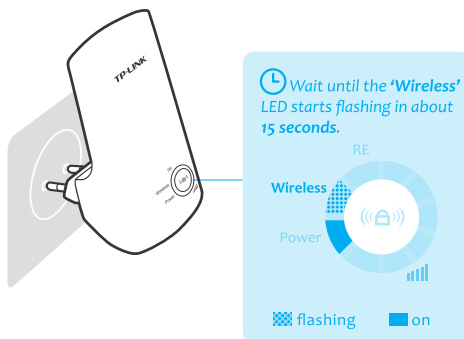

2 Push the two WPS buttons

① Push the WPS button on your router/AP according to its instructions.

② Within 2 minutes, push the «A» button on your TL-WA854RE.

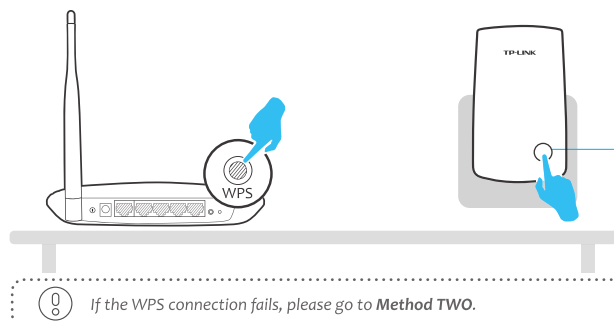

3 Relocate

Once your TL-WA854RE is properly configured, you can move it to a more ideal location for optimal signal quality and range extension. Once placed in another power outlet, the extender will **reconnect to the main router automatically in about 30 seconds**. *Keep these in mind:

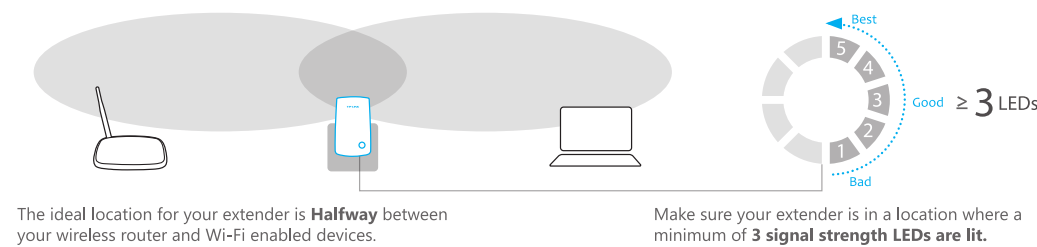

Keep the extender as far away from devices like cordless phones, Bluetooth devices and microwave ovens as possible to minimize wireless frequency interference.

Try to place your extender in **open corridors or spacious locations** rather than a crowded room.

Enjoy!

The TL-WA854RE **shares** the same Wi-Fi network name(SSID) and **Wi-Fi password** with your main router/AP.



FAQ(Frequently Asked Questions)

Q1. How to reset the TL-WA854RE?

Tip 1: Use a pin to press the RESET button on the bottom of the TL-WA854RE for 2 seconds while it is plugged into a power outlet. Wait 5 seconds until all of the TL-WA854RE's LEDs **flash once**.
Tip 2: Log into the management page via your web browser, then go to "System Tools -> Factory Defaults" and click "Restore". Wait 5 seconds until all of the TL-WA854RE's LEDs **flash once**.

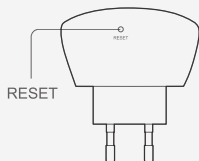

Q2. I typed <http://tplinkextender.net> in the browser URL bar, why can't I see the quick setup page?

Tip: First, make sure your computer is connected to the extender network and disconnected from any other network. Second, make sure your computer is set to obtain an IP address automatically.

Q3. What's the technical support hotline?

Tip: Please visit www.tp-link.com, find **Support>Contact Technical Support>Hotline Support** for more information. Other forms of support are also available on our website.

Method TWO Setup using your Web Browser

1 Power on

Plug your TL-WA854RE in **near** your router or AP.

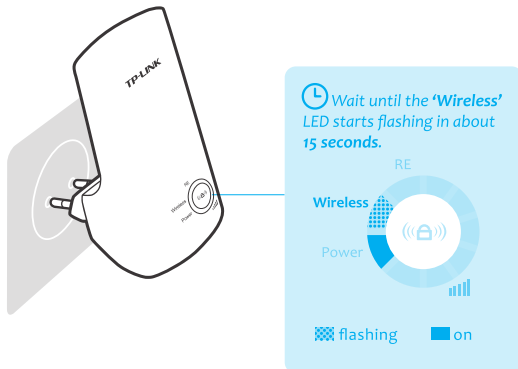

2 Connect your computer to the TL-WA854RE

- 1 Disconnect your Ethernet Connection.
- 2 Click the **Wireless Network Connection** icon on your desktop.
 
- 3 Click the **refresh** icon ⚡ and connect to the TL-WA854RE (the default wireless network name is: **TP-LINK_Extender_XXXXXX**) and continue to **Step 3**.

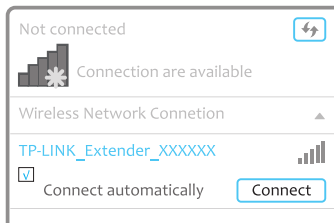

3 Configure via your Web Browser

- 1 Type in **http://tplinkextender.net** in your Web browser and press **Enter**. Log in management page using user name "**admin**" and password "**admin**".

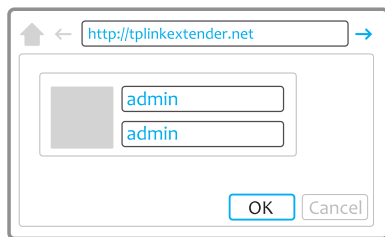

 It will take approximately 5 seconds or more until the above login page pops up. If it still does not pop up even if you refresh the browser, please go to the [FAQ](#)>> Q2.

- 2 Below are the major steps of the setup process.

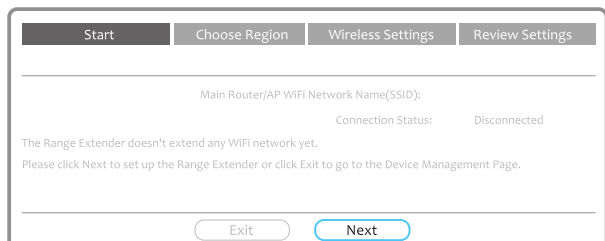

a. After logging in, you will see the **Quick Setup** page.

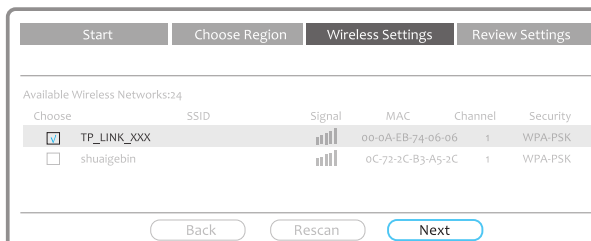

b. Select your router/AP's Wi-Fi network, for example, **TP_LINK_XXX**.

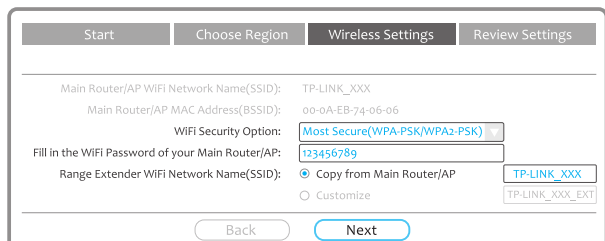

c. Fill in the **Wi-Fi Password of your main router/AP**. TL-WA854RE's **Wi-Fi network name (SSID)** can be copied from your main router/AP (**TP-LINK_XXX**) or be customized (**TP-LINK_XXX_EXT**).



d. After completing the configuration, **check the LED lights**. Several (1~5) signal strength LEDs will light up if the configuration is successful.

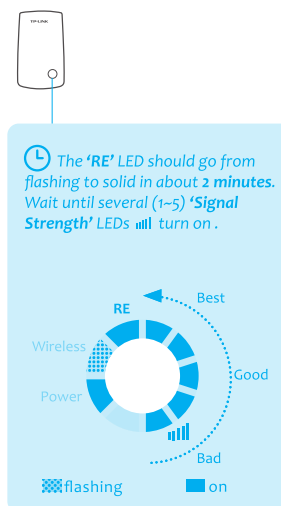

4 Relocate

 Flip this piece of paper. Step 4 is the same as Step 3 of **Method ONE**.

 **Enjoy!**

Choose TL-WA854RE's **Wi-Fi network name** (TP-LINK_XXX or TP-LINK_XXX_EXT). The TL-WA854RE **shares the same Wi-Fi password** with your main router/AP.

